

### DESCRIPTION

The **ATV-5** is a wall amplifier specifically designed to send audio signals from a television to a nearby room through a ceiling speaker. This solution is designed mostly for applications such as hotel rooms where you need to send the television audio signal to the bathroom.

Its compact and light design enables the equipment in any surface while optimizing the space.

The amplifier also provides an internal sensibility's adjustment that allows to adjust the input level to the output audio level of the television to reach an optimal level.

The equipment requires a power supply source of 12VDC (not provided with the equipment). UDE recommends the WV-12 model.

### TECHNICAL FEATURES

- Amplifier:	<b>5 W.</b>
- Speaker output:	4-16 Ω .
- Input sensitivity:	10 mV. (Adjustable internal knob).
- SNR:	94 dB.
- Distortion:	Below a 1%.
- Maximum Consumption:	0,8 A.
- Power supply:	+12 VDC. (mediante F.A. WV-5).

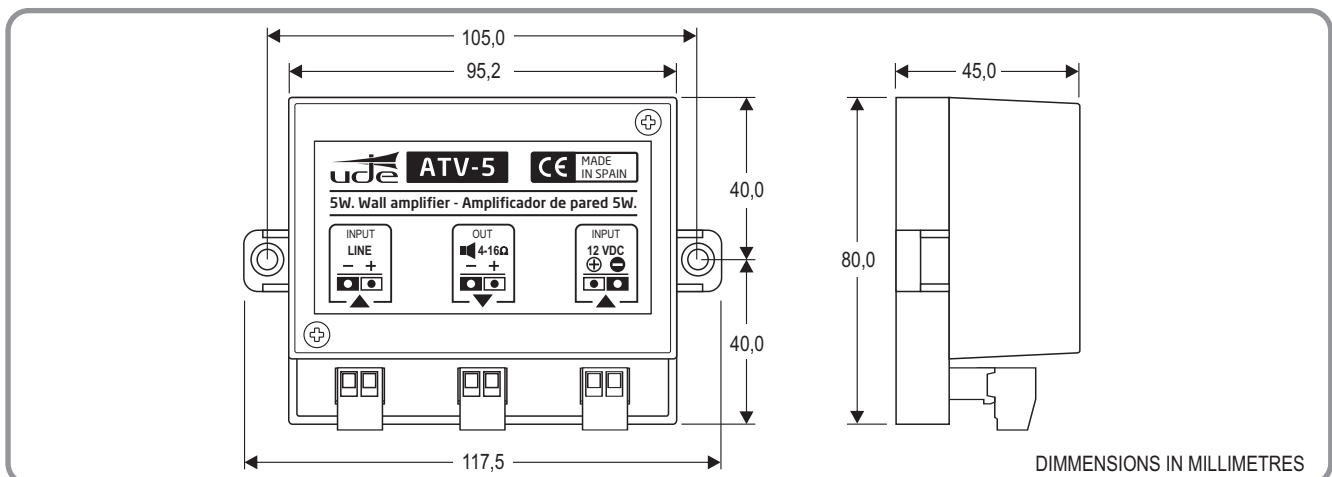

**INSTALLATION**

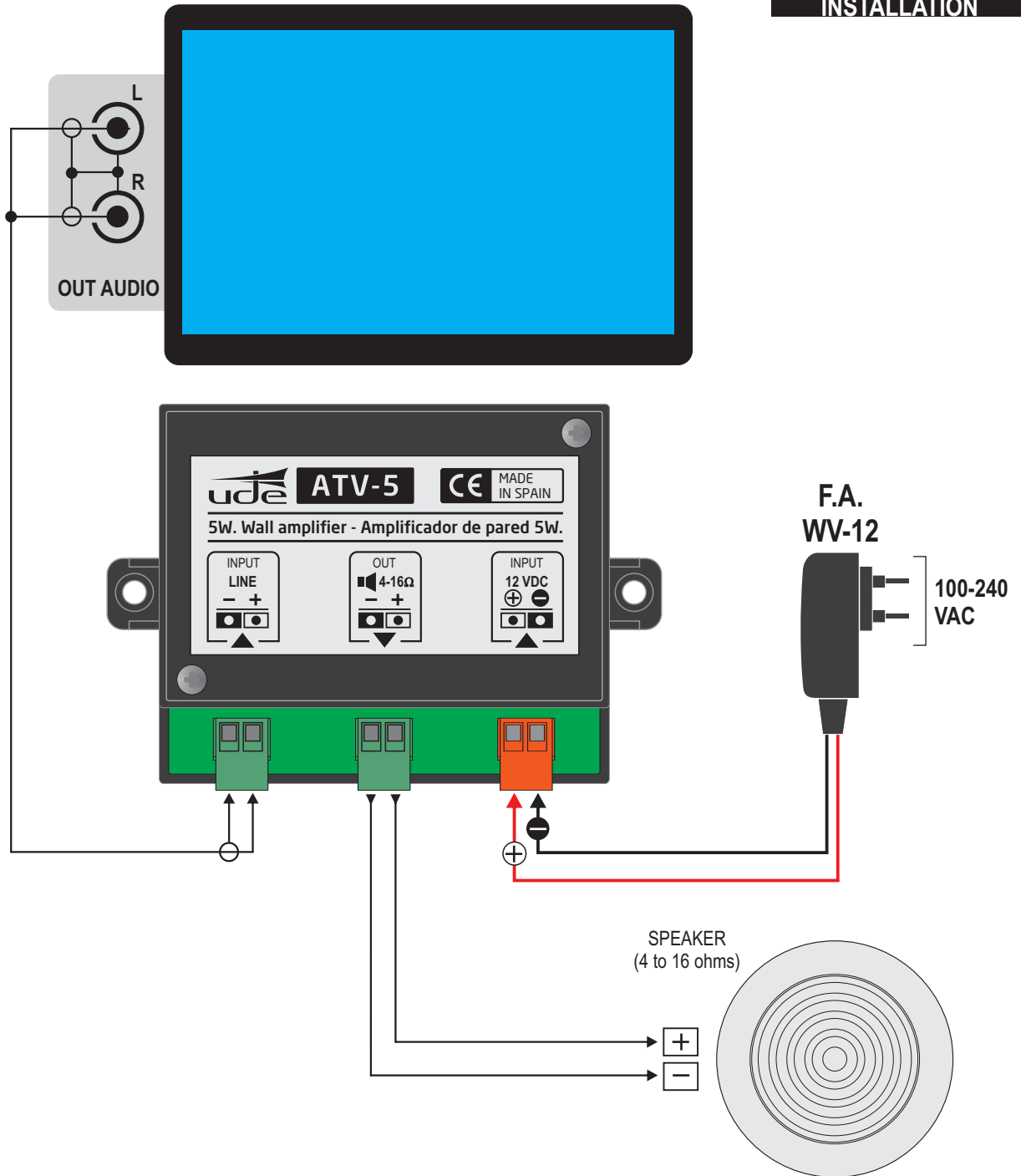

**SENSIBILITY'S ADJUSTMENT**

- Pull the cover by unscrewing the two frontal screws.

The internal sensibility's adjustment allows to adjust the input level to the output audio level of the television to reach an optimal level. This adjustment must be manipulated exclusively by technical staff.

